

Aldreds
Estate Agents



Vue Riviere Marsh Lane

Burgh Castle, NR31 9QH

Offers Over £255,000



3



1



1



F

Vue Riviere Marsh Lane

, NR31 9QH

A rare and exciting opportunity to acquire a spacious three-bedroom detached bungalow, offered CHAIN FREE, in a highly sought-after, quiet location. Boasting generous room sizes throughout, this home is perfectly positioned for a buyer looking to create their dream residence. It features a detached garage and a private driveway, providing ample off-road parking.

The property is ripe for renovation, allowing the new owner to truly put their stamp on the interiors. Outside, you will benefit from a lovely south-facing garden, making it an ideal sun trap for outdoor entertaining or peaceful relaxation. Comfort is assured with oil fired central heating, and the potential for modernization is vast. Viewing is highly recommended.

Porch

Carpet floor, double glazed window to front, door to side, access to entrance hall.

Entrance Hall

Carpet floor, built in meter plus storage cupboard, access to 3 bedrooms, lounge, bathroom and WC. Airing cupboard access plus access to loft.

Lounge

15'1" x 10'2" (4.6m x 3.1m)

Carpet floor, double glazed windows to front and side, open brick fire place, radiator, access to kitchen.

Kitchen

9'10" x 10'2" (3.0m x 3.1m)

Vinyl floor, double glazed window to side, door to rear utility, tiled work tops with under counter and wall mounted storage, integrated sink and draining board, oven and grill and electric hob with extractor fan.

Utility

6'10" x 3'11" (2.1m x 1.2m)

Carpet floor, double glazed window and door to rear, space for washing machine, oil boiler.

Bedroom 1

13'5" x 10'2" (4.1m x 3.1m)

Carpet floor, double glazed window to rear, radiator, corner shower cubicle.

Bedroom 2

11'5" x 10'2" (plus wardrobe space) (3.5 x 3.1m (plus wardrobe space))

Carpet floor, double glazed window to side, radiator, built in wardrobe.

Bedroom 3

11'9" x 10'2" (3.6m x 3.1m)

Carpet floor, double glazed window to front, radiator, built in storage cupboard and drawers.





Bathroom

4'7" x 6'10" (1.4m x 2.1m)

Carpet floor, double glazed window to rear, basin and bath tub with shower connected to taps.

WC

2'11" x 4'7" (0.9m x 1.4m)

Carpet floor, double glazed window to side, WC.

Outside Front

Grass lawn, pond, concrete driveway leading to garage, brick wall boundaries to sides and front, monkey puzzle tree.

Outside Rear

Lawn, concrete path, access around then side to the front, garage with up and over door, timber fence boundaries, concrete coal bunker.

Tenure

Freehold

Services

Mains water, drainage, electric, oil fired central heating.

Location

Burgh Castle is a semi rural village 2 miles west of Gorleston and 4 miles from Great Yarmouth * The River Waveney and Breydon Water are on the outskirts of the village giving access to the Norfolk and Suffolk Broads * There is a yacht marina and historic Roman Castle ruins.

Council Tax

Great Yarmouth Borough Council - Band C

Directions

Heading away from Gorleston on Beccles Road (A143), continue through Bradwell and take the third exit off the roundabout onto New Road towards Belton. At the mini roundabout, take the second exit onto Stepshort which leads into Butt Lane. Follow Butt Lane all the way to the end and at the 'T' junction, turn right onto High Road and then left before The Queens Head Public House onto Back Lane. Take the first left onto Marsh Lane.

What 3 Words

///amuse.confined.reissued

Ref

G18412/11/25

AGENCY NOTE

Please note this property is of non-standard timber frame construction. Please speak to Aldreds Sales for further information.



Floor Plan

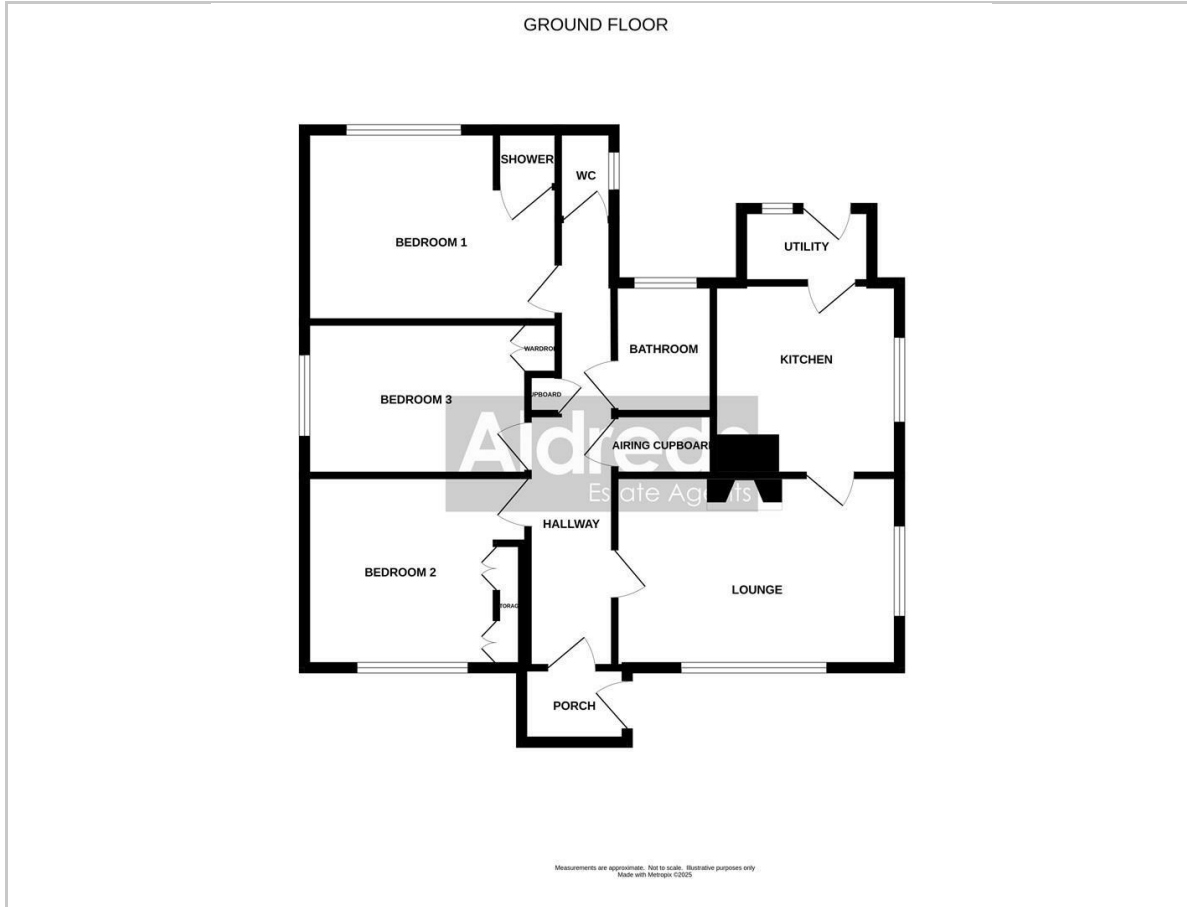

Area Map



Viewing

Please contact our Aldreds Gorleston Office on 01493 664600 if you wish to arrange a viewing appointment for this property or require further information.

Disclaimer

These particulars are issued on an understanding that all negotiations shall be conducted through Messrs. Aldreds. Please note: Messrs. Aldreds for themselves and for the vendors or lessors of this property whose agents they are given notice that: 1. Particulars are set out as a general outline only for guidance of intending purchasers or lessees, and do not constitute nor constitute part of, an offer or contract. 2. All descriptions, dimensions, references to condition and necessary permissions for use and occupation, and other details are given without responsibility and any intending purchasers or tenants should not rely on them as statements or representations of fact but must satisfy themselves by inspection or otherwise as to the correctness of each of them. 3. No person in the employment of Messrs. Aldreds has any authority to make or give any representation or warranty whatever in relation to this property. 4. If you are proposing to visit the property and are travelling some distance please check with Aldreds on the issue of availability prior to travelling. 5. Aldreds Property Consultants and associated services may offer additional services to the prospective purchaser for which they will be entitled to receive a commission.

Aldreds are pleased to be working with Mortgage Advice Bureau. They're an award-winning mortgage broker with over 1,400 advisers across the UK, and have access to over 12,000 mortgage products from over 90 lenders. Aldreds Estate Agents Ltd receive a commission of £200 on each completed case. Your home may be repossessed if you do not keep up repayments on your mortgage. There may be a fee for mortgage advice. The actual amount you pay will depend upon your circumstances. The fee is up to 1%, but a typical fee is 0.3% of the amount borrowed. Mortgage Advice Bureau is a trading name of Mortgage Seeker Limited which is an appointed representative of Mortgage Advice Bureau Limited and Mortgage Advice Bureau (Derby) Limited which are authorised and regulated by the Financial Conduct Authority. Mortgage Seeker Limited Registered Office: Lovewell Blake, Sixty Six North Quay, Great Yarmouth, Norfolk, NR30 1HE. Registered in England Number: 03721415. 6. Potential purchasers should check with their providers that the broadband and mobile phone coverage they would require is available.

Energy Efficiency Graph

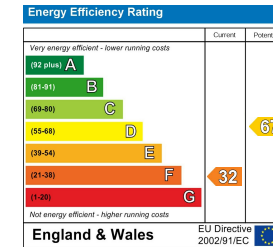

149 High Street, Gorleston, Norfolk, NR31 6RB

Tel: 01493 664600 Email: gorleston@aldreds.co.uk <https://www.aldreds.co.uk/>

Registered in England Reg. No. 08945751 Registered Office: 17 Hall Quay, Great Yarmouth, Norfolk NR30 1HJ

Directors: Mark Duffield B.S.c. FRICS. Dan Crawley MNAEA Paul Lambert MNAEA